

Electric vehicle AC charging pile ZD01

Instruction manual



Please read this instruction manual carefully before using the product. Thank you for using this series of charging piles!

If you encounter any questions during use, please contact the customer service of the purchase channel, and a professional will answer your questions.

Due to the need for continuous improvement of the product, this data product is subject to the physical object, and our company reserves the right to update the product.

01 Important security information

Before installing and using this product, please read through the instructions to

check all warnings and precautions.

- ▲ Warning: Do not install or use this product near flammable, explosive, rough or combustible materials, chemicals or steam.
- ▲ Warning: Please turn off the power on the circuit breaker before installing or cleaning this product.
- ▲ Warning: This equipment should be strictly guarded when using it in places where children appear.
- ▲ Warning: This product must be connected through a permanent wire system or equipment wire.
- ▲ Warning: This product is used only according to the specified operating parameters.
- ▲ Warning: Do not spray water or other liquids directly on the control box installed on the wall. Do not spray water on the charging handle or immerse the charging handle in liquid. Please put the charging handle into the protective seat to avoid unnecessary contamination or moisture.
- ▲ Warning: Do not use this product if it is defective, cracked, worn, or other damage, or does not work properly.
- ▲ Warning: Do not use this product if the soft power cord or EV cable is worn, cracked or other damage, or does not work properly.
- ▲ Warning: Do not attempt to disassemble, repair, tamper with or modify this product. This product is not a user-repairable device.
- ▲ Warning: Please be careful when shipping this product. Do not subject it to strong force or impact or pull, twist, tangle, drag or trample on the product to prevent damage to itself or components.
- ▲ Warning: Do not use your fingers or sharp metal objects (such as wires, tools or needles) to touch the end of this product.
- ▲ Warning: Do not insert fingers or foreign objects into any part of this product.
- ▲ Warning: Do not forcefully fold or apply pressure on any part of this product or use sharp objects to destroy it.
- ▲ Warning: The use of this product may affect or damage the operation of medical or implantable electronic devices, such as implantable pacemakers or implantable electrocardiogram defibrers. Before using this product, please consult the electronic equipment manufacturer about the impact of charging on such electronic devices.

02 Precautions

- ▲ Do not use a private generator as a charging power supply;
- ▲ The working range of this product is $-20^{\circ}\text{C} \sim +50^{\circ}\text{C}$, please do not operate it at a temperature beyond this range;
- ▲ This product is strictly forbidden to use after soaking in water. It can be used normally in the rain, and try to avoid using it in heavy rain;
- ▲ If the charging gun cable of this product is damaged and the charging gun shell is broken, it is strictly forbidden to use it. Please contact the after-sales service;
- ▲ When charging this product, it is necessary to couple the gun head and the vehicle interface in place; the connection indicator light (blue light flow) indicates that the charging gun has been connected to the vehicle;
- ▲ When using this product to charge, if there is a child nearby, it is recommended to reasonably restrain the child. It is strictly forbidden to operate or pull the product, or play around the product;
- ▲ When charging this product, try to avoid exposing the charging gun to the rain to avoid unnecessary losses;
- ▲ Do not touch metal conductors when using high currents during the working process to prevent electric shock accidents;
- ▲ The shell of the product charging gun is thermoplastic. Don't let it be impacted by external forces to avoid damage;
- ▲ When charging, try to avoid winding the gun line, and try to avoid friction between the gun line and the ground to damage the outer skin of the cable;
- ▲ After charging is completed, first disconnect the charging button on the car, then press the mechanical lock hook on the charging gun, remove the charging gun, and insert the charging gun into the charging gun bracket. It is strictly forbidden to discard the charging gun on the ground to avoid its damage;
- ▲ The wrong installation and testing of this product may damage the vehicle's battery, components and AC charging pile itself. Any damage caused thereby is not covered by the warranty;
- ▲ The installation height of this product should be 0.5-1.5m from the ground;

This product can be used both indoors and outdoors.

Note: AC charging piles must be installed by electrical system personnel who have been trained and qualified to obtain the operation qualification certificate.

03 Product overview

The product is designed based on **IEC 62196-2, IEC 61851-1**.

This product is mainly composed of charging pile host, charging gun, installation accessory package, etc. It is a household electric vehicle charging equipment. The AC pile is safely and reliably charged by the charging gun interface through access to the municipal electricity. There are no corrosive gases such as acid and alkali in the surrounding environment to avoid affecting the performance of the product. Try to avoid direct rain or use in an environment where the temperature is too high, and try to prevent damage to the shell.



04 Product parameters

Serial number	Technical indicators	Parameters		
		1	Product patent	ZL 2022 3 0862689.4
2	Rated input/output voltage	AC 230V	AC 400V	AC 400V
3	Rated input/output current	32A max	3X16A max	3×32A max

4	Rated power	7KW	11KW	21KW
5	Security function	Low-voltage protection, high-voltage protection, over-current protection, short-circuit protection, overload protection, leakage protection, low-temperature protection, high-temperature protection, lightning protection, grounding protection, emergency stop protection, CP abnormal protection		
6	Working environment Temperature/humidity	-20°C~+50°C / 5% ~ 95%		
7	Working altitude	<2000m		
8	Shell protection level	IP55		
9	Cooling method	Natural air cooling		
10	Installation method	Wall-mounted/column type		
11	Start-up mode	Plug and charge, swipe card, fingerprint, APP		
12	Take-up mode	lower wiring, under the line		
13	Cable length	3/5/10 meters		
14	Mainframe size	325*220*100mm		
15	Implementation standards	IEC 62196-2,IEC 61851-1		

05 Product function description

Serial Number	Function	Function Description	Display	Notes
1	Display screen	The display shows the real-time charging capacity, charging time, and host temperature.		
2	Charging current	Adaptive matching current according to the vehicle		
3	Plug and charge	Plug in the gun to charge.		
4	Swipe cards	Swipe the card to charge.		Card-swiping version only
5	Fingerprint identification	Fingerprint identification to charge.		Fingerprint identification version only
6	APP	Mobile APP can operate for charging and family sharing WIFI: Remote operation for charging Bluetooth: operation for charging at 10 meters		APP version only
7	Appointment time	Book the charging time according to your needs.		APP version only
8	Voice prompt	There are voice prompts for use steps.		Voice version only
9	Low voltage protection	7KW version: the input voltage is lower than AC 89V start-up protection; 11KW, 21KW version: (single-phase calculation, single-phase 89V) start-up protection	E1	The voltage resumes charging normally.
10	High-voltage protection	7KW version: input voltage higher than AC 270V start-up 11KW, 21KW version: (single-phase calculation, single-phase 270V) start-up protection	E2	The voltage resumes charging normally.
11	Overcurrent	Start protection in case of	E3	Pull out the gun to

	protection	overcurrent		remove the protection
12	Short-circuit protection	Start protection in case of short circuit	E4	Pull out the gun to remove the protection
13	Overload protection	Start protection in case of overload	E5	Pull out the gun to remove the protection
14	Leakage protection	Start-up protection in 100mS if leakage AC current 30mA or 6mA DC	E6	Pull out the gun to remove the protection Power off and restart
15	Low temperature protection	Start protection in case of charging pile temperature below -25°C	E7	Higher than -20°C to remove protection
16	High temperature protection	Start protection in case of temperature of the charging pile higher than 85°C	E8	Less than 50°C to remove protection
17	Emergency stop protection	Press the emergency stop button to start the protection during charging.	E9	Pull out the gun to remove the protection
18	CP abnormal protection	start protection if charging pile and car handshake fails	E10	Pull out the gun to remove the protection

Note: Some vehicles will not be automatically unprotected due to vehicle restrictions, and the protection needs to be removed after pulling out the gun.

06 Instructions for use

1. Connect the charging pile to the input power supply, and the green light will breathe and light up.
2. After the user inserts the charging gun in a standardized manner, the blue light will flow dynamically.
3. Select the following steps to authorize the startup of the main unit:
 - 3.1 Take out the charging card of the electric vehicle and swipe the card at the card swiping area of the main unit to authorize the startup of the main unit.
 - 3.2 Authorize the startup of the main unit through the APP software (please refer to the

APP operation steps for specific binding).

3.3 Authorize the startup of the main unit through fingerprint recognition (please refer to the fingerprint entry steps for specific entry).

4. After the authorization is successful, the charging pile will charge the vehicle normally, the icon will light up, the green light will breathe, and the charging data will be displayed on the display screen.

5. During the normal charging process, if the vehicle's on-board system supports the manual charging stop function, after the user activates this function, pressing the start charging button can resume charging.

6. After the vehicle is fully charged, the charging time will stop counting, the display screen will show the charging amount of this session, the green light will stay on. At this time, the user can pull out the charging gun (for some vehicle models, the gun lock needs to be opened before the gun can be pulled out), and the entire charging process is completed! The charging pile will enter the standby mode.

***Note: Please power on first and then insert the charging gun before authorizing.**

07 Indicator Light Instructions



Serial Number	Item	Indicator Light Strip Display
1	Standby	Green light breathing
2	Charging Gun Inserted	Green light staying on
3	Charging	Blue light breathing
4	Charging Completed	Blue light staying on
5	Charging Fault	Red light breathing

08 System setup instructions

When the charging card is not bound, the charging pile has no anti-theft charging function, and it is the plug-and-play charging version.

In order to ensure the safety of your charging pile, please bind the charging pile in time.

Serial	System projects	Display screen	Display screen legend
--------	-----------------	----------------	-----------------------

number			
1	Entering the system	SEt	
2	Binding the charging card	-1	
3	Unbinding the charging card	-2	
4	Binding APP (WiFi + Automatic Bluetooth)	-3	
5	Unbinding APP (WiFi + Automatic Bluetooth)	-4	
6	Binding the user's fingerprint	-5	
7	Unbinding the user's fingerprint	-6	

How to enter the system for settings?

1. After binding the charging pile, you can enter the system for settings.
2. The charging pile is powered on, and the first card or the authorization of fingerprint administrator is used to unlock the charging pile.
3. The charging gun is not connected to the end of the car. Long press the SET key for 3 seconds, enter the system settings, and click to switch.
4. If you accidentally touch the system settings, press the SET key for 3 seconds to exit, and the charging pile will enter standby mode.

09 Bind/unbind the charging card.

■ Bind the charging card

1. Bind the first card: the charging pile is powered on and the charging gun is not connected to the car terminal. Long press the SET key for 3 seconds, the screen appears 60 seconds countdown -1. The user swipes card within 60 seconds of the screen countdown, and the green light is always on, which means the first card is successfully bound.

2. Binding card 2: Use the bound charging card to start the charging pile (see 08 system settings instructions for details). Enter the system settings, click the SET key to switch to -1 mode. The user swipes card within 60 seconds of the screen countdown, and the green light is always on, which means the first card is successfully bound.

3. Follow-up card binding is the same as Card 2.

■ Unbind the charging card

1. Use the bound charging card to start the charging pile (see the 08 system setting instructions for details). Enter the system settings, and click the SET key to switch to -2 mode. The user swipes card within 60 seconds of the screen countdown, and the green light is always on, which means unbinding all charging cards;

2. The charging pile only supports unbinding all charging cards. Please refer to the operation instructions for re-binding the card (binding the charging card).

Note: In card-swiping version of the charging pile, after unbinding, the anti-theft charging function will be lost. Please operate with caution. If the first card is lost and cannot obtain authorization to unbind, please contact customer service to solve the problem.

10 Input/clear the user's fingerprint

■ Input the user's fingerprint

1. Fingerprint input requires the first card authorization and enter the system settings. The first two fingerprints are the administrators, and the third is an ordinary user, and up to 50 fingerprints can be input.

2. The first card authorization (see 08 system setting instructions for details) enters the system settings and click the SET key to switch to -5 mode. The user completes the fingerprint input within 60 seconds of the screen countdown, "press -> release" 6 times, and the light changes accordingly. After 6 successful identifications, the fingerprint light is green and bright, which means fingerprint's successful input.

3. The fingerprint red light is always on, that is, the fingerprint input fails. The fingerprint needs to be re-input.



■ Clear the user's fingerprint

1. First card authorization (see 08 system setup instructions for details) for entering the charging pile system settings, and click the SET key to switch to -6 mode. The administrator presses the fingerprint module within 60 seconds of the screen countdown to complete the authentication. The green light is always on, that is, all fingerprints have been cleared.

Note: Only the administrator has the right to clear the fingerprint, and the operation will clear all fingerprints. If you need to start and stop with fingerprint, you need to re-input.

11 Bind/unbind APP operation instructions (optional version)

■ Bind APP

1. Turn on WIFI on the mobile phone and connect to the network (5G frequency band is not supported for the time being, and if there is no WIFI in the location, you can use another device to transmit a hotspot to connect), and turn on the Bluetooth switch;

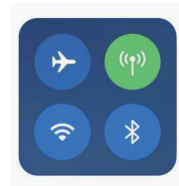
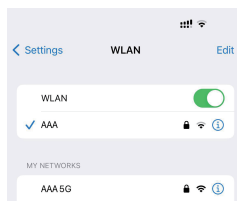
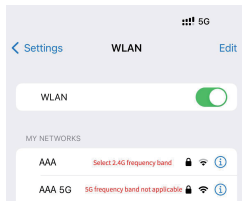

2. Download and install the "Smart Life" APP in major application markets of mobile phone. Open the APP for the first time and register an account. After registration, enter the APP homepage interface;



Smart Life

3. Click Add Settings on the home page, and find the button Addition of Device account password connected to the mobile phone, and click Next to add the device. If the addition fails, please disconnect the charging pile input power and try repeatedly;

e. Input the WIFI
ce. If the addition

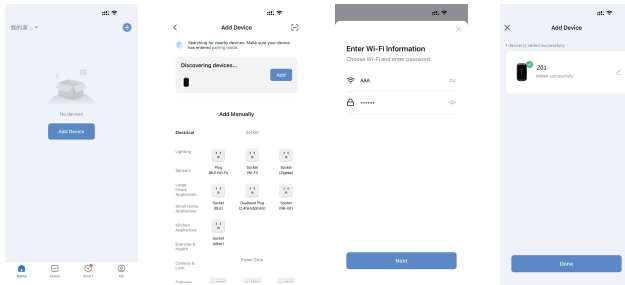

■ Unbind APP

1. Bind the mobile phone and open the APP on the home page and long press the device;
2. Click Remove Device to complete the unbinding.

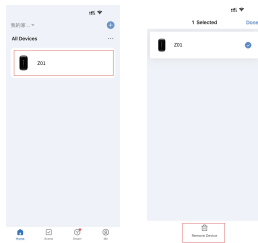

■ Use the APP to charge

1. Click on the home page equipment;
2. Select charging mode, instant charging, quantitative charging and delayed charging;
3. Slide the switching on to start charging;
4. Click Settings to view the device information

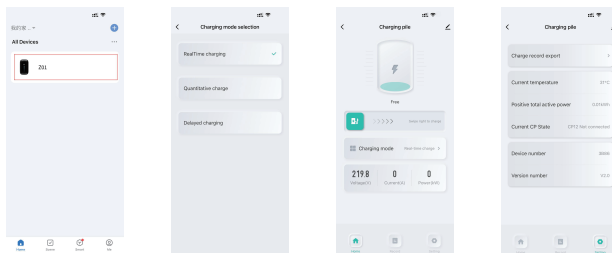

■ Family sharing

1. Click me to enter home management;
2. Choose to create a home to share the device.

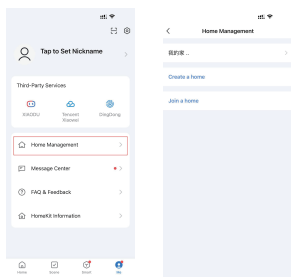

12 Common faults and treatment methods of charging

tables

Serial number	Common faults	Possible causes	Treatment methods
1	The display is not on.	Poor power connection	Check whether the power cable is charged and whether the switch is connected or tripped.
2	Unable to start the charging function	The charger is not fully connected.	Please check whether the charging gun is reliably connected to the vehicle and whether the gun lock is locked.
		The charging card does not match the charging pile.	Please use the correct board to start charging. If the card is lost, please contact the customer service center to replace it.
3	The charging current is less than the rated current.	Equipment failure or vehicle near full power	When the vehicle battery is close to full, the charging current drops, which is normal. If it is not for the above situation, please contact the manufacturer for repair.
4	After charging, the gun lock can't be removed.	The car is locked.	Check whether the car has the function of locking the gun head, click to unlock the lock and then pull the gun; Restart the charging process and wait for it

			<p>to jump the gun after the power is cut off.</p> <p>If this method still can't be pulled out, please contact the manufacturer for repair.</p>
5	Network failure	Electric pile internal network module failure, screen display E11	Power off and restart
6	Card swiping failure	The card swiping module inside the charging pile fails, and the screen shows E12	Power off and restart
7	Fingerprint identification failure	The fingerprint module inside the charging pile is faulty, and the screen shows E14	Power off and restart
8	Other failures	Touch the fingerprint module by mistake when the fingerprint has not been entered, and the screen shows E15	No fingerprints are input in the new charging pile , and users need to input it by themselves.

13 Packing list

Serial Number	Project	Notes
1	AC charging pile host	With gun line (including charging gun)
2	Installation of the backplate	
3	Installation accessory package	<p>Screw expansion tube * 4</p> <p>Screws*4</p> <p>Limit screw * 1</p>

4	Instructions for use	
5	Certificate of conformity	
6	Electric vehicle charging card	3

14 Installation precautions

- 1.This product must be installed by electrical system personnel who have been trained and qualified to obtain the operation qualification certificate.
- 2.The wrong installation and testing of this product may damage the vehicle's battery, components or AC charging pile itself. Any damage caused thereby is not covered by the warranty.
- 3.Before installation, please confirm whether the basic equipment meets the requirements: special distribution cables and meters need to be laid and installed where the product is pre-installed.
- 4.Do not install this product near flammable, explosive, dry or flammable materials, chemicals or steam.
- 5.Before installation, please make sure to turn off the power on the circuit breaker.
- 6 .For the three-phase specification of this product, a 400V three-phase electricity meter needs to be applied for in advance, and the capacity shall not be less than 22kw. The specification of the matching input cable should be at least a standard cable with 5 cores and a cross-sectional area of 6 square millimeters. If the cable length exceeds 100 meters, the cable specification needs to be improved according to your own power conditions.

15 Installation process

- The installation height of this product should be 0.5-1.5m from the ground;
- Drill 4 mounting holes on the wall or column according to the size requirements;
- Then knock the screw expansion tube into 4 mounting holes respectively;
- Put the installation backplate in the corresponding place of 4 installation holes, and fix the installation backplate to the wall with 4 screws;
- Place the mainframe facing the installed backplane, point the plug at the jack on the mounting backplane, and then insert it into place;
- Tighten the side limit screw.

Note: The column needs to be selected separately. The product does not have screw accessories for the column installation.

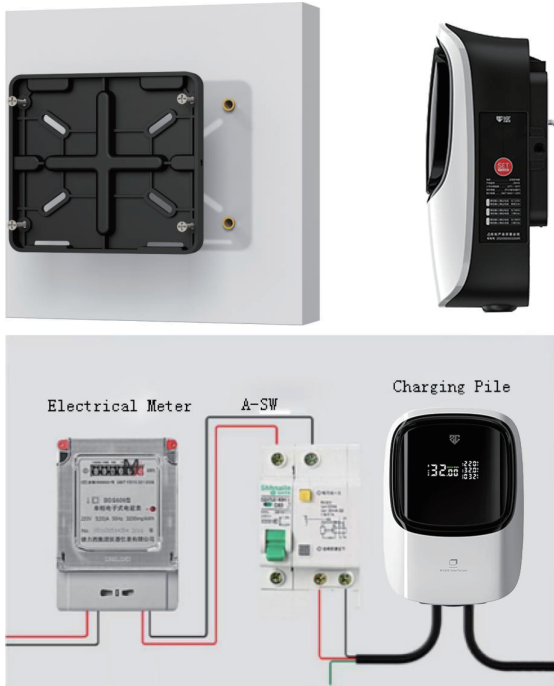

16 Warranty regulations

1. The product quality is guaranteed for two years from the date of purchase of this product;
2. During the warranty period, the failure (judged by the official staff of the company) caused by the normal use of the product in accordance with the instruction manual shall be repaired free of charge.
3. During the warranty period, if one of the following situations occurs, it must be repaired for a fee:
 - (1) This warranty card and valid proof of purchase cannot be provided.
 - (2) Failure and damage caused by wrong installation, testing, private disassembly, man-made actions, poor storage.
 - (3) Failures and damage caused by wrong use and improper repair.
 - (4) Failure and damage caused by long-distance delivery, moving and falling after purchase.
 - (5) Failure and damage caused by inevitable external factors like irresistible floods, fires, lightning strikes, earthquakes, adverse environment, natural disasters
 - (6) Damage caused by waterlogged devices like improper use with water and rain and other solutions
 - (7) Damage caused by power supply and voltage that is specified.
4. Only the above warranties are made, and no other express or implied warranties (including implied warranties of merchantability, rationality and adaptation to a particular application, etc.) The company is not responsible for any special, incidental or indirect damage, whether in the contract, civil negligence, or others.